



JIS GROUP

TEST INSTRUCTIONS THROUGH APP VERSION



JIS Perfectice

Perfectice LLC Education

3+

 This app is compatible with all of your devices.

App Link - https://play.google.com/store/apps/details?id=jisu.myperfectice.com&hl=en_IN

Important Note:

1. Make sure you have good internet connection while starting the test and while submitting the test.
2. **You have to download the APP if you need to appear from mobile phone. You CANNOT give the test in your phone web version.**
3. Please login 30 mins before the exam.
4. **Log in 30 minutes prior** to check the login credentials, the test will be visible from the starting time only.
5. Do not minimize the app, otherwise your test will be terminated after several warnings.
6. **Do not switch networks** (wifi or mobile data) or devices between the tests, once the test has started finish without any changes.
7. Your APP should be in the **latest version**.
8. If the update appears then please update the app.
9. The phone DND mode so that you don't receive any incoming calls.
10. All the notifications of different app should be put off.
11. You can use your own hardware calculator.
12. Please logout after test is successfully submitted.
13. Always **allow the CAMERA**, whenever the pop up appears.

Step 1: Go to play store and download the App 'JIS Perfectice'

Link is --->

<https://play.google.com/store/apps/details?id=jisu.myperfectice.com>

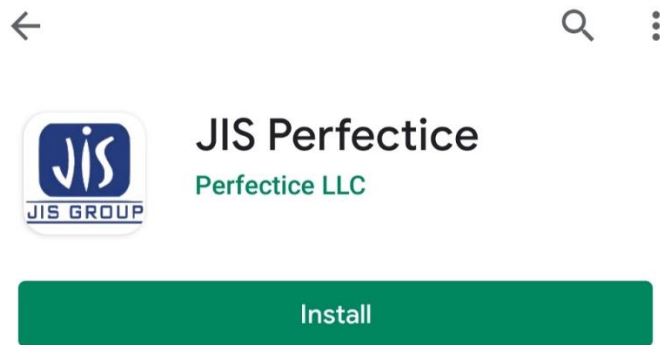

Step 2: Open the app. Then click on 'Allow'.

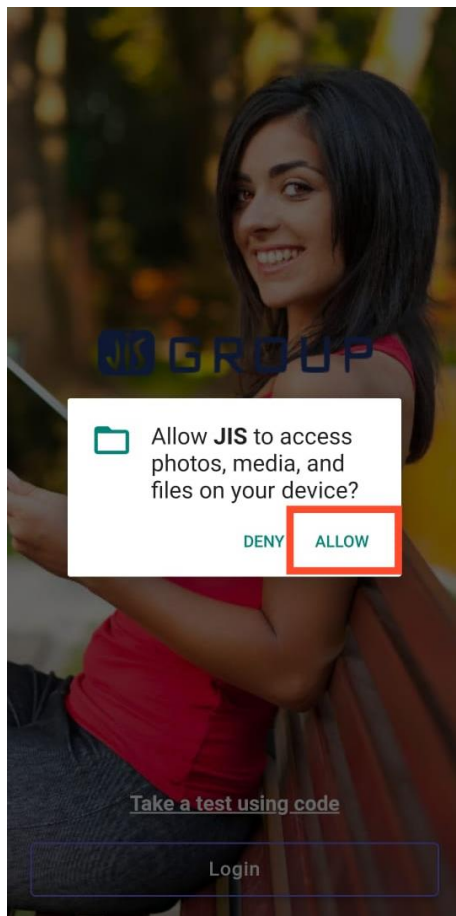

Step 3: Click on 'Login'



Step 4:

Login with your registered email or phone no.

Provide correct password.

Then click on 'Login'

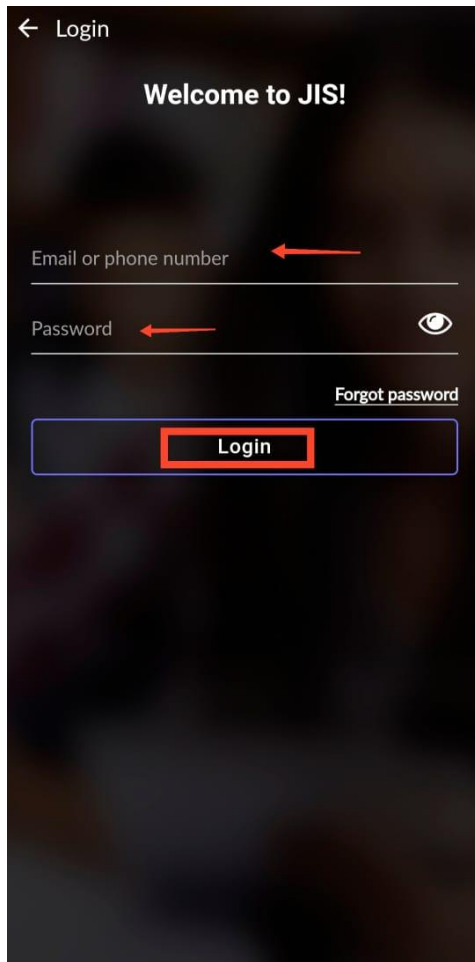

Step 5: You will see the test with test name.

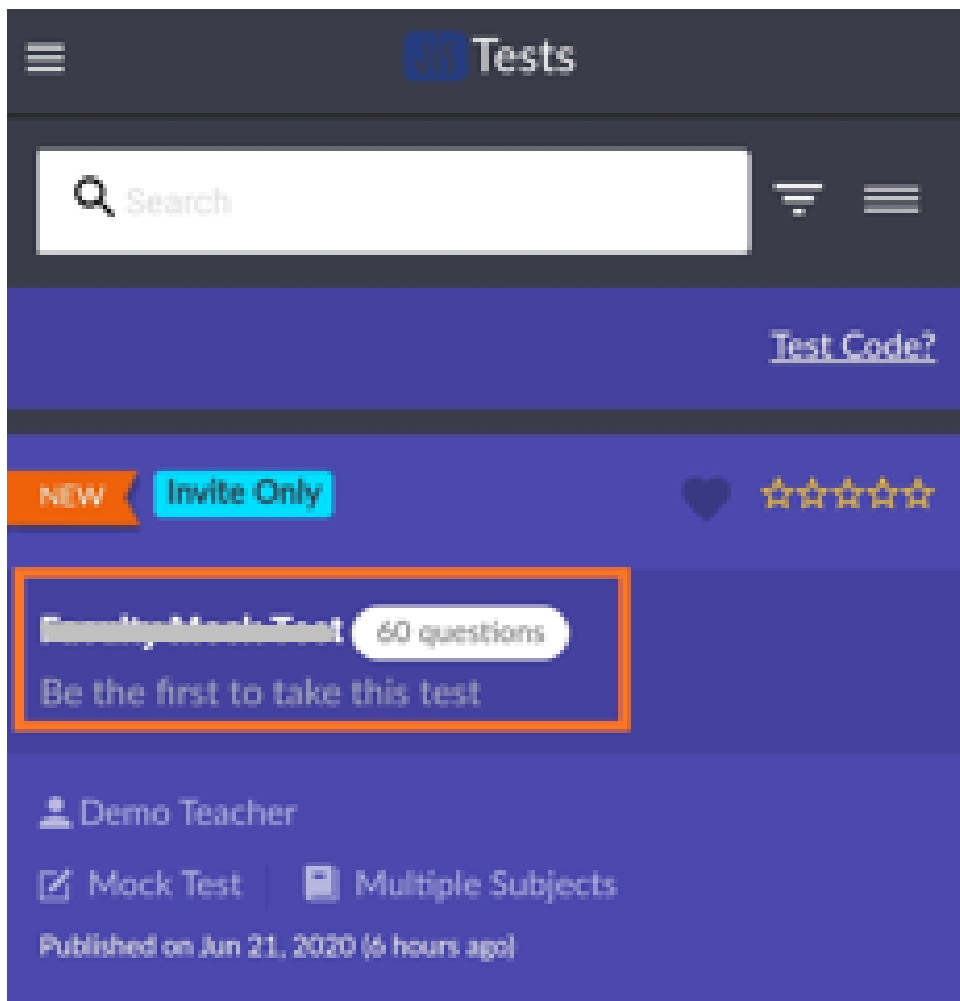

Step 6: Click on the test and then click on 'START TEST'

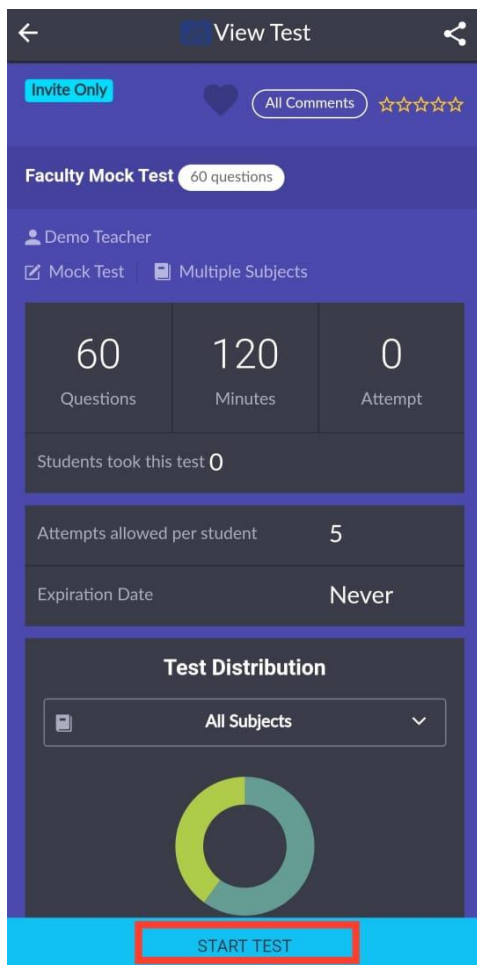

Step 7: Instruction page will be displayed with all the instructions. So read all the instructions carefully. Then click on 'START TEST'

← Start Test

Faculty Mock Test 60 questions

General Instructions

- This test consists of objective type questions. Students can click on the check box next to the options and choose the right answer from the choices provided.
- Student can use rough sheets while taking the test. Do not use calculators; log tables, dictionaries, or any other printed/online reference material during the tests unless specifically mentioned in the exam instructions.

→ NEXT

Students can save their response and move to the next question.

Missed Questions (28)

1	2	3	4	5	6	7	8
9	10	11	12	13	14	15	16
17	18	19	20	21	22	23	24
25	26	27	28				

Students can access questions in any order by clicking on a number from the list. With each attempted question the number of missed questions (unattempted questions) will keep disappearing from that list.

□ 👁 MARK FOR REVIEW

This button enables students to mark

- 

MARK FOR REVIEW

This button enables students to mark answers for review later and proceed to next question.
- Marked for Review (3)** ▾



A question marked for review will appear in black color. The Students can review these answers after completing the test or anytime during the test.
- Reasoning Ability (3)** ▾



Subject Dropdown shows attempted questions in blue color and unattempted questions in yellow color for that topic.
- 

MARK FOR REVIEW

Students can unmark questions marked for review by clicking this button.

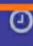
- 

23:13 mins

If the examination time expires before you complete reviewing the "Marked for Review" list, then originally chosen option will be taken as a final answer by the system.
- 

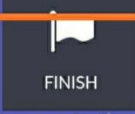
Shows the language switch for a question which has multilingual support. Students can click on it to change language of the question.
- 

FINISH

On clicking this button system prompts the students to end the test and give their comments and feedback along with providing an option to share the test with friends

START TEST ←

Step 8: Click on 'ALLOW'

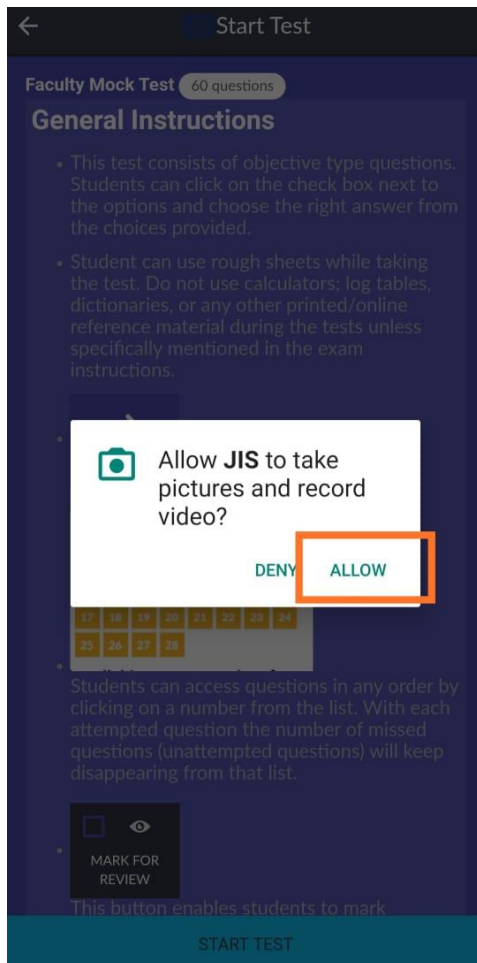

Step 9: You will able to see the following things:

- 1) Time left for the test
- 2) Question no.
- 3) Marks contain in that particular question
- 4) Question belonging to which Section.

Keep your face inside the square box so that your face can be viewed on the screen.

For every movement the video is being recorded which your college will view.

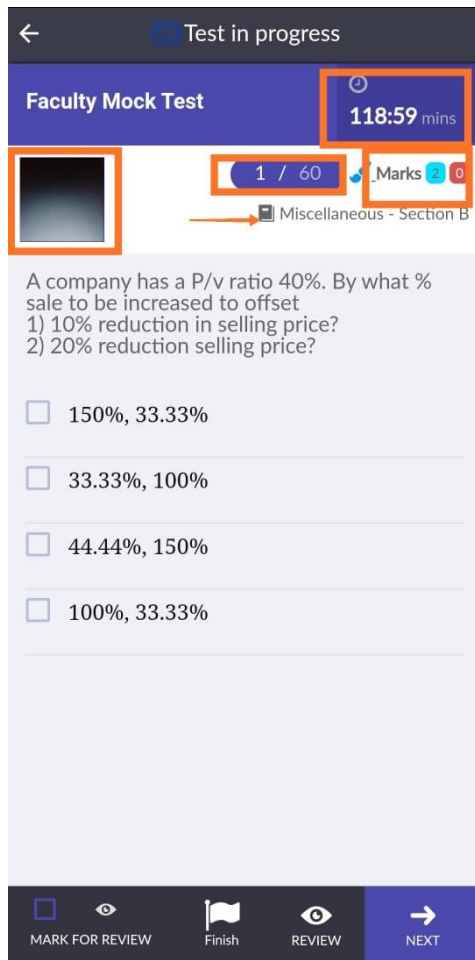

Step 10: By clicking on the review, you will get to see following tabs:

- 1) Missed Questions
- 2) Marked for Review
- 3) Sections

The screenshot shows a mobile application interface for a 'Faculty Mock Test'. At the top, there is a dark blue header with a back arrow, the text 'Faculty Mock Test', and a timer showing '77:42 mins'. Below the header, there are three main sections, each with a red rectangular highlight around its title:

- Missed Questions (60)**: This section contains a grid of 60 yellow buttons, numbered 1 through 60. The buttons are arranged in 8 rows: the first seven rows have 8 buttons each, and the eighth row has 4 buttons (57, 58, 59, 60).
- Marked for Review (0)**: This section shows the text 'No questions marked for review'.
- Miscellaneous - Section B (24)**: This section is a dropdown menu with a downward arrow.
- Miscellaneous - Section A (36)**: This section is a dropdown menu with a downward arrow.

At the bottom of the screen, there is a large blue button labeled 'SUBMIT'.

Step 11: By clicking on the section tab, questions will be displayed according to the sections

Faculty Mock Test

41	42	43	44	45	46	47	48
49	50	51	52	53	54	55	56
57	58	59	60				

Marked for Review (0)

No questions marked for review

Miscellaneous - Section B (24)

1	2	3	4	5	6	7	8
9	10	11	12	13	14	15	16
17	18	19	20	21	22	23	24

Miscellaneous - Section A (36)

25	26	27	28	29	30	31	32
33	34	35	36	37	38	39	40
41	42	43	44	45	46	47	48
49	50	51	52	53	54	55	56

SUBMIT

Step 12:

- 1) Read the questions thoroughly.
- 2) If instruction is provided then read the instruction by clicking on it.
- 3) Then click the option which you consider as correct.

← Test in progress

Faculty Mock Test 103:29 mins

3 / 60 Marks 0

Miscellaneous - Section B

[See instruction for this question](#)

In a chemostat with cell recycle , the feed flow rate and culture volumes are $F= 100\text{ml/h}$ and $V=1000\text{ml}$, respectively. The system is operated under glucose limitation, and the yield coefficient, $Y_{X/S}^m$, is 0.5 gdw cells/g substrate. Glucose concentration in the feed is $S_0 = 10 \text{ g glucose/l}$. the kinetic constants of the organisms are $m_m = 0.2 \text{ h}^{-1}$, $K_s = 1\text{g glucose/l}$. the value of C is 1.5 , and the recycle ratio $a = 0.7$. the system is at steady state. Find the cell (X_1 biomass) concentration in the recycle stream.

2.2-3.5 g/l

1.3-1.5 g/l

6.1-8.1 g/l

Step 13:

1) If you are having doubt in any question and want to review it afterwards then mark the question as 'MARK FOR REVIEW'

In a chemostat with cell recycle, the feed flow rate and culture volumes are $F = 100 \text{ ml/h}$ and $V = 1000 \text{ ml}$, respectively. The system is operated under glucose limitation, and the yield coefficient, $Y_{X/S}^m$, is 0.5 gdw cells/g substrate. Glucose concentration in the feed is $S_0 = 10 \text{ g glucose/l}$. The kinetic constants of the organisms are $\mu_m = 0.2 \text{ h}^{-1}$, $K_s = 1 \text{ g glucose/l}$. The value of C is 1.5 , and the recycle ratio $\alpha = 0.7$. The system is at steady state. Find the cell (X_1 biomass) concentration in the recycle stream.

2.2-3.5 g/l

1.3-1.5 g/l

6.1-8.1 g/l

None of these

MARK FOR REVIEW Finish REVIEW PREVIOUS NEXT

2) After marking it for review, it will appear like this.

← Test in progress

3 / 60 Marks

Miscellaneous - Section B

Question for this question

In a chemostat with cell recycle, the feed flow rate and culture volumes are $F = 100 \text{ ml/h}$ and $V = 1000 \text{ ml}$, respectively. The system is operated under glucose limitation, and the yield coefficient, $Y_{X/S}^m$, is 0.5 gdw cells/g substrate. Glucose concentration in the feed is $S_0 = 10 \text{ g glucose/l}$. The kinetic constants of the organisms are $\mu_m = 0.2 \text{ h}^{-1}$, $K_s = 1 \text{ g glucose/l}$. The value of C is 1.5 , and the recycle ratio $\alpha = 0.7$. The system is at steady state. Find the cell (X_1 biomass) concentration in the recycle stream.

2.2-3.5 g/l

1.3-1.5 g/l

6.1-8.1 g/l

None of these

MARK FOR REVIEW Finish REVIEW PREVIOUS NEXT

3) For example,

As here we marked question no. 3 as 'Marked for Review'. So, it will not appear in 'Missed Question' tab. But will be appear in 'Marked for Review' tab



Step 14: In the section colors indicated the following things:

- 1) Color blue =already attempted
- 2) Color yellow=not yet attempted /or missed question.
- 3) Color black=marked for review

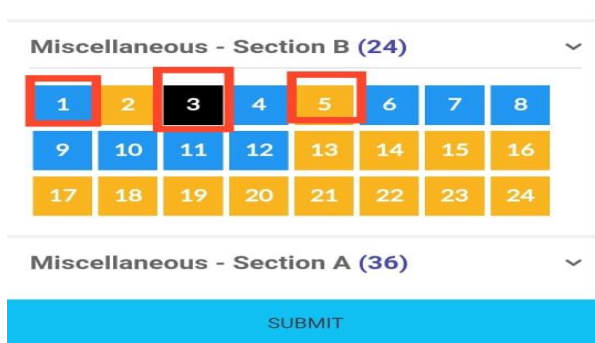

Step15:

- 1) By clicking on 'Previous' tab, you can go to your previous question.
- 2) By Clicking on 'Next' tab, you can go to your next question.

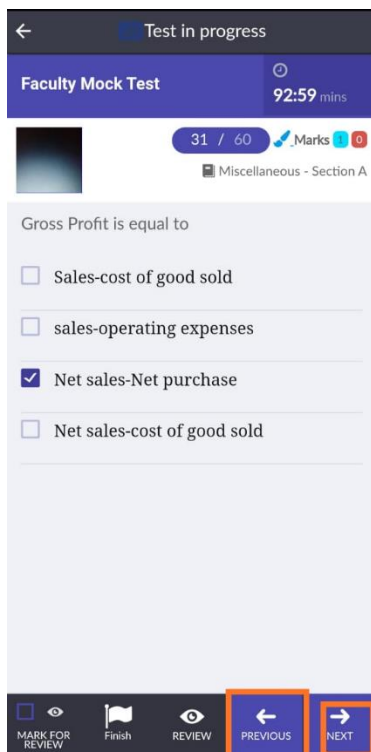

Step 16: During the test you can receive the **warning message** for the following:

- 1) If you get any phone call.**
- 2) If you receive any notification from any app**
- 3) If you minimize the Perfectice app, etc.**
- 4) Moving out of the screen**
- 5) Moving your mouse pointer out of the maximum page**

If you receive such do not worry, click on OK and continue.

After the number shown the test will be terminated, therefore, Close all the notification during the test, and try not to receive any Incoming calls

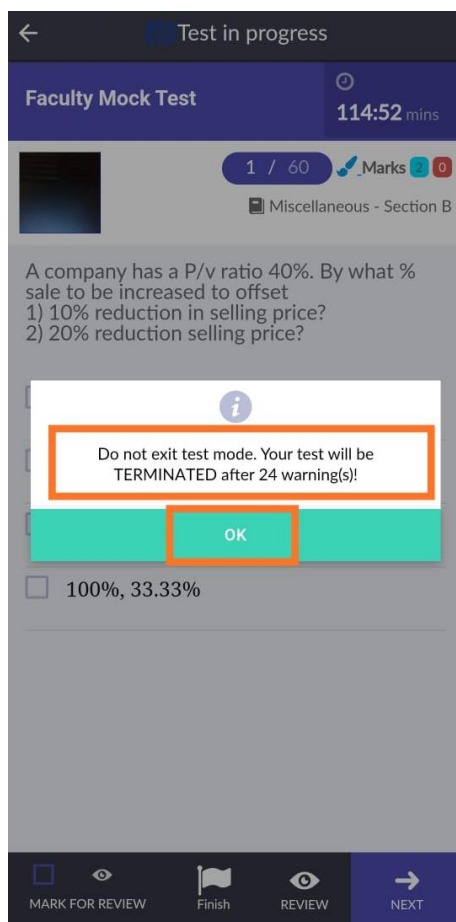

Step 17: After completing click on 'SUBMIT' button.

← Faculty Mock Test

60

for Review (1)

Miscellaneous - Section B (24)

1	2	3	4	5	6	7	8
9	10	11	12	13	14	15	16
17	18	19	20	21	22	23	24

Miscellaneous - Section A (36)

25	26	27	28	29	30	31	32
33	34	35	36	37	38	39	40
41	42	43	44	45	46	47	48
49	50	51	52	53	54	55	56
57	58	59	60				

SUBMIT

Step 18: After clicking on the submit button you will receive the following message. So, click on 'OK'

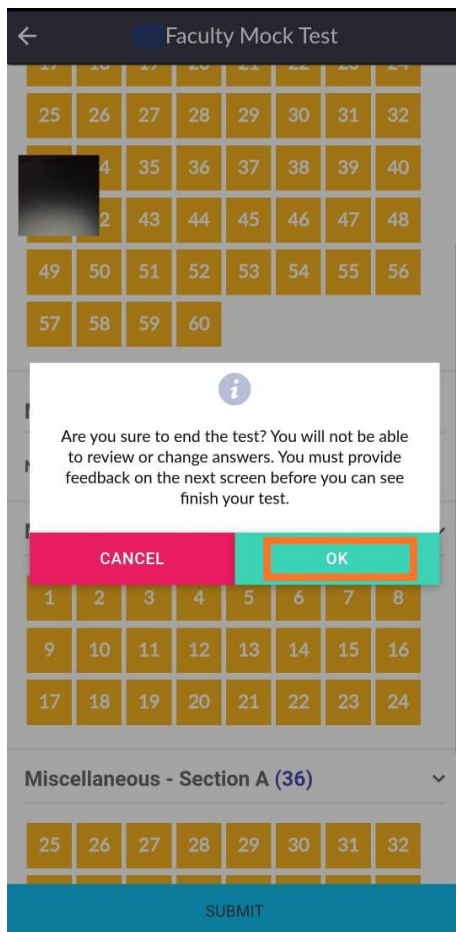

Step 19: If the test is attempted successfully, then the test will appear with 'attempted' symbol.

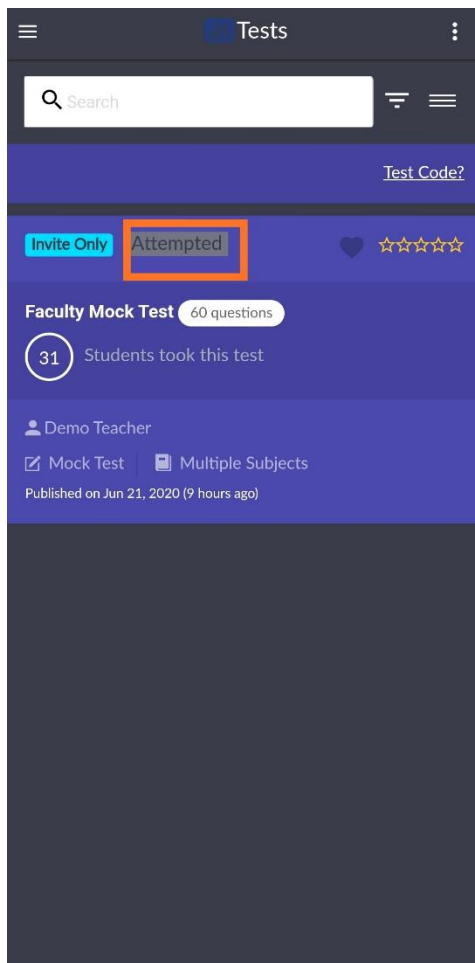

-----**THANK YOU**-----